



Municipal District of Taber
LAND OWNER REQUEST FOR APPROACH

_____ hereby makes request to
to construct/have installed, an approach at the following location(s):

_____ 1/4 _____ Sec. _____ Twp. _____ Rge. W4M

The approach shall be located on Township Road _____
or Range Road _____

as indicated on the diagram below:

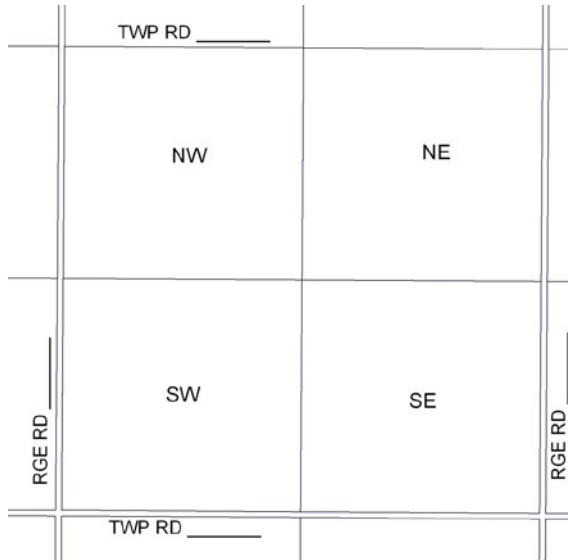

Owner's Name and Email Address : _____

Owner's Signature

Owner's Phone Number

Please note: there is a required fee of \$100.00 to accompany any new approach applications, and a required fee of \$50.00 to amend any existing approach